

Universal type fan coil unit

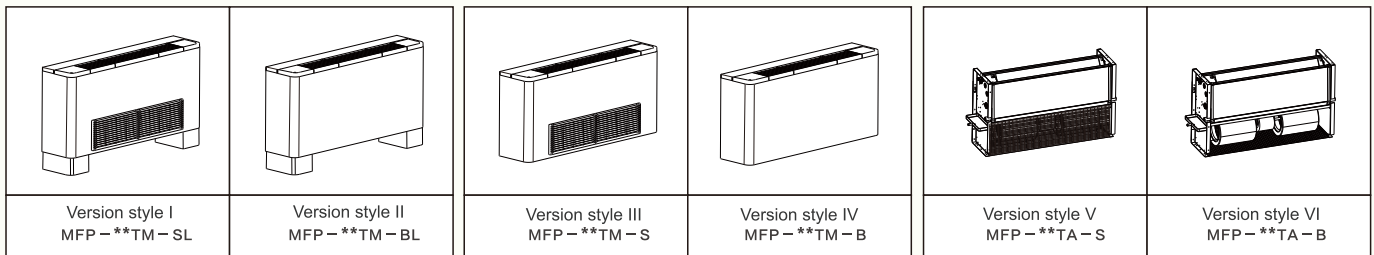

Characteristic

- 1、 Universal design, the unit can be installed by vertical or horizontal.
- 2、 Classical elegant design.
- 3、 Use PVC drain pan with 2 water outlet, hollow structure design can enhance the thermal insulation properties, at the same time to prevent from leaking.
- 4、 Left-Right water pipe connection can be changed freely.
- 5、 6 kind of air distribution solution is optional ;

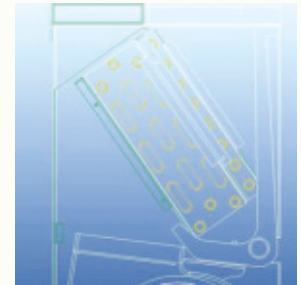

Installing dimension

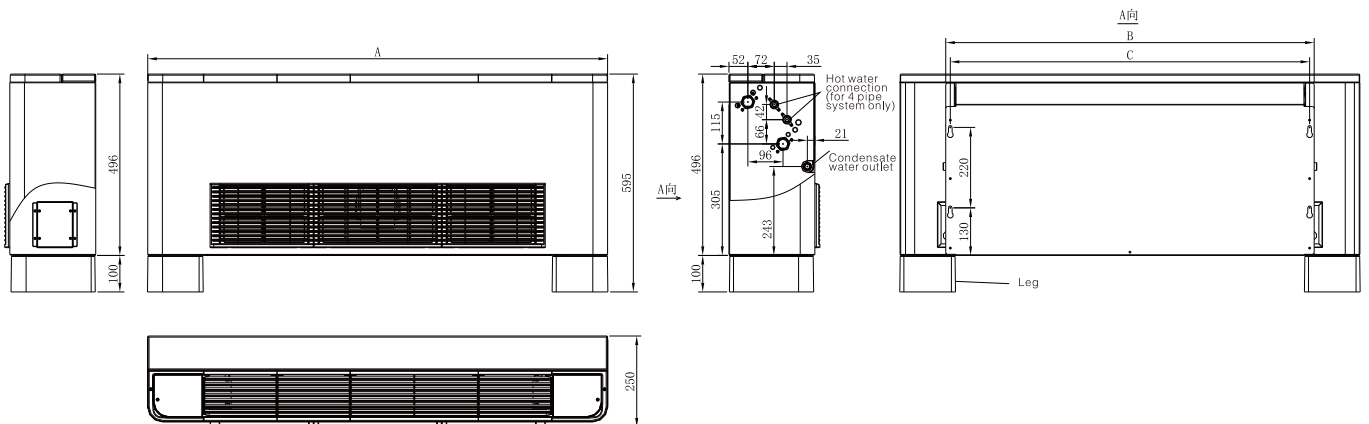

Unit: mm

MODEL	MFP-34TM	MFP-51TM	MFP-68TM	MFP-85TM	MFP-102TM	MFP-136TM	MFP-170TM	MFP-204TM	MFP-238TM
A	858	908	1058	1208	1258	1608	1758	1908	2058
B	608	658	808	958	1008	1358	1508	1658	1808
C	583	633	783	933	983	1333	1483	1633	1783
Qty of fan	1	2	2	2	2	4	4	4	4
Qty of motor	1	1	1	1	1	2	2	2	2

Universal type fan coil unit (2-tube system)

Model		MFP-34TM	MFP-51TM	MFP-68TM	MFP-85TM	MFP-102TM	MFP-136TM	MFP-170TM	MFP-204TM	MFP-238TM		
Power supply		220V,50Hz,1Ph										
Air volume	H	340	510	680	850	1020	1360	1700	2040	2380		
	M	260	390	510	640	770	1020	1280	1530	1790		
	L	170	260	340	430	510	680	850	1020	1190		
Cooling capacity	TH	H	W	1800	2700	3600	4500	5400	7200	9000	10800	12600
			BTU/h	6142	9212	12283	15354	18425	24566	30708	36850	42991
		W	1368	2052	2736	3420	4103	5471	6839	8207	9575	
	SH	H	BTU/h	4668	7001	9335	11669	13999	18667	23335	28002	32670
			W	1494	2242	2989	3736	4483	5978	7472	8967	10461
		W	1181	1771	2362	2952	3541	4722	5903	7084	8265	
	TH	M	W	1162	1744	2325	2906	3487	4649	5812	6974	8136
			W	953	1430	1907	2383	2860	3813	4765	5718	6672
		W	2700	4050	5400	6750	8100	10800	13500	16200	18900	
Heating capacity	M	2131	3197	4262	5328	6393	8524	10655	12786	14917		
	L	1675	2511	3349	4186	5024	6697	8372	10046	11721		
	W	1300	1940	2590	3240	3890	5180	6480	7780	9070		
Noise	High speed	dB(A)	37	39	41	43	45	46	48	50	51	
Power input	High speed	W	37	52	62	76	96	134	152	189	228	
Waterflow volume	High speed	m ³ /h	0.31	0.46	0.62	0.77	0.93	1.23	1.54	1.85	2.16	
Pressure dropping		kPa	7	15	18	23	28	30	22	30	36	
Water tube connection(inlet)			ZG3/4"	ZG3/4"	ZG3/4"	ZG3/4"	ZG3/4"	ZG3/4"	ZG3/4"	ZG3/4"		
Water tube connection(outlet)			ZG3/4"	ZG3/4"	ZG3/4"	ZG3/4"	ZG3/4"	ZG3/4"	ZG3/4"	ZG3/4"		
Coil	Type	high efficient copper pipe to wear Hydrophilic aluminum coil										
Maximum working pressure	MPa	1.6	1.6	1.6	1.6	1.6	1.6	1.6	1.6	1.6		
Condensation pipe size (diameter)	mm	φ 16										

Universal type fan coil unit (4-tube system)

Model		MFP-34TM4	MFP-51TM4	MFP-68TM4	MFP-85TM4	MFP-102TM4	MFP-136TM4	MFP-170TM4	MFP-204TM4	MFP-238TM4		
Power supply		220V,50Hz,1Ph										
Air volume	H	340	510	680	850	1020	1360	1700	2040	2380		
	M	260	390	510	640	770	1020	1280	1530	1790		
	L	170	260	340	430	510	680	850	1020	1190		
Cooling capacity	TH	H	W	1800	2700	3600	4500	5400	7200	9000	10800	12600
			BTU/h	6142	9212	12283	15354	18425	24566	30708	36850	42991
		W	1368	2052	2736	3420	4103	5471	6839	8207	9575	
	SH	H	BTU/h	4668	7001	9335	11669	13999	18667	23335	28002	32670
			W	1494	2242	2989	3736	4483	5978	7472	8967	10461
		W	1181	1771	2362	2952	3541	4722	5903	7084	8265	
	TH	M	W	1162	1744	2325	2906	3487	4649	5812	6974	8136
			W	953	1430	1907	2383	2860	3813	4765	5718	6672
		W	1300	1940	2590	3240	3890	5180	6480	7780	9070	
Heating capacity	M	1020	1530	2040	2550	3060	4070	5090	6110	7130		
	L	820	1230	1630	2040	2450	3270	4080	4900	5720		
	W	1300	1940	2590	3240	3890	5180	6480	7780	9070		
Noise	High speed	dB(A)	37	39	41	43	45	46	48	50	51	
Power input	High speed	W	37	52	62	76	96	134	152	189	228	
Waterflow volume	High speed	Cooling tube	m ³ /h	0.31	0.46	0.62	0.77	0.93	1.23	1.54	1.85	2.16
		Heating tube	m ³ /h	0.11	0.17	0.22	0.28	0.34	0.45	0.56	0.67	0.78
Water Pressure dropping		Cooling tube	kPa	7	15	18	23	28	30	22	30	36
		Heating tube	kPa	2.8	6	7.2	9.2	11.2	12	8.8	12	14.4
Water tube connection(inlet)			ZG3/4"	ZG3/4"	ZG3/4"	ZG3/4"	ZG3/4"	ZG3/4"	ZG3/4"	ZG3/4"		
Water tube connection(outlet)			ZG 1/2"	ZG 1/2"	ZG 1/2"	ZG 1/2"	ZG 1/2"	ZG 1/2"	ZG 1/2"	ZG 1/2"		
Coil	Type	high efficient copper pipe to wear Hydrophilic aluminum coil										
Maximum working pressure	MPa	1.6	1.6	1.6	1.6	1.6	1.6	1.6	1.6	1.6		
Condensation pipe size (diameter)	mm	φ 16										