



WALL - MOUNTED BOILER

# PIGMA ULTRA

The silent heart of the range.

With its level of sanitary comfort classified \*\*\* according to the EN13203 standard, Pigma Ultra puts comfort within everyone's reach. Compact for all households, simple and practical, Pigma Ultra meets the needs of current and future thermal legislation. In this range, Pigma Ultra is the boiler that offers the most advantages.



## ENERGY CLASS (1)



### > SANITARY COMFORT

- **Stainless steel plate heat exchanger.**
- Domestic hot water comfort rated 3 stars according to the EN13203 standard.
- **Domestic hot water flow rate from 14.2 to 15.8 L/min with  $\Delta T = 25\text{ }^{\circ}\text{C}$ .**
- Turbine-controlled DHW production to meet all needs, even unexpected ones.
- Programmable comfort function.

### > HEATING COMFORT

- Combustion efficiency classification: 3 stars according to the EN 92/42 standard (FF model).
- **Model designed for integration into an EBUS2 heating system (solar and hydraulic modules, accessories for modulation control).**
- **SRA function that allows automatic regulation of the system in order to guarantee the optimal functioning of the heating system regardless of the environmental conditions.**
- Backlit LCD screen with black icons and segments on a white background with display of history operating modes and temperatures, and the results of self-diagnostic procedures.
- Anti-freeze function.

### > EASE OF USE AND INSTALLATION



- Compatible with the Expert Control system: new intuitive room control device to manage 3 circuits depending on the room and/or outside temperature for greater comfort and energy savings.
- New intuitive electrical wiring
- Easier commissioning: automatic degassing function and combustion control function with direct access.
- Simplified maintenance: all components are accessible from the front.
- Connectivity (thanks to Expert Control)
- Full modulation pump.

### > ENERGY SAVING AND RESPECT FOR THE ENVIRONMENT



- Additional savings of up to 15 % with Expert Control System, which includes a modulating room sensor.

### MULTI ENERGY SOLUTIONS:

To optimize gas combustion, the Pigma Ultra boiler can be combined with our solar solutions to meet all needs.

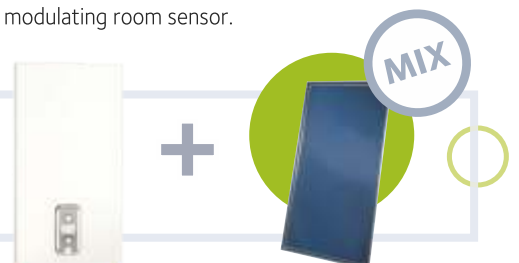

(1) Modèles 25 CF et 30 CF

Width  
40-44 cmPower  
25-30 kWDHW production  
INSTANTTechnology  
CONVENTIONAL

## PIGMA ULTRA

## TECHNICAL DATA

	PIGMA ULTRA	25 FF	30 FF	35 FF	25 CF	30 CF
Gas Category		II2H3P				
Boiler Type		C12-C22-C32-C42-C52-C62-C82-B22-B22p-B32 - C12X-C32X-C42X-C52X-C82X			B11 - B11bs	
<b>PERFORMANCES ÉLECTRIQUES</b>						
Maxi/mini. nominal heat flow rate (Hi)	kW	25.8 / 11.0	30.0 / 13.0	34.5 / 15.0	25.8 / 11.0	29.5 / 13.0
Maxi/mini. nominal heat input (Hs)	kW	28.7 / 12.2	33.3 / 14.4	38.3 / 16.7	28.7 / 12.2	32.8 / 14.4
Maxi/mini. heat flow rate for hot water (Hi)	kW	25.8 / 11.0	30.0 / 13.0	34.5 / 15.0	27.0 / 11.0	30.5/13.0
Maxi/mini. heat flow rate for hot water (Hs)	kW	28.7 / 12.2	33.3 / 14.4	38.3 / 16.7	30.0 / 12.2	33.9 / 14.4
Maxi/mini heating capacity	kW	24.0 / 9.5	28.1 / 11.6	32.3 / 13.2	23.7 / 9.9	26.5 / 11.2
Maxi/mini. DHW heating capacity	kW	23.6 / 10.0	27.4 / 11.9	32.2 / 14.0	25.0 / 10.2	27.9 / 11.9
Combustion efficiency (at smoke evacuation) Hi/Hs	%	93.7	93.8	93.9	92.7	92.8
Gross efficiency of nominal heat input (60/80 °C) Hi/Hs	%	93.1 / 83.8	93.6 / 84.3	93.6 / 84.3	91.9 / 82.8	89.9 / 81.0
30% gross yield at 47 °C Hi/Hs	%	93.3 / 84.0	93.7 / 84.4	92.6 / 83.4	91.2 / 82.1	89.7 / 80.8
Efficiency at minimum power Hi/Hs	%	86.7 / 78.1	89.3 / 80.4	88.2 / 79.4	90.2 / 81.2	86.5 / 77.9
Yield (performance) classification (Directive 92/42/CEE)	stars		***			**
Maxi. thermal loss through the envelope ( $\Delta T = 50^{\circ}C$ )	%	0.6	0.2	0.3		
Heat/thermal loss through smoke evacuation when the burner is ignited	%	6.3	6.2	6.1		
<b>EMISSIONS</b>						
Residual evacuation gauge height	Pa	120	145	130		
NOx class	classe		3			2
Temperature of evacuated gas (G20)	°C	117	110	112	116	125
CO <sub>2</sub> content (G20)	%	6.5	6.1	6.4	5.4	6.1
CO content (0 % O <sub>2</sub> )	ppm	60	111	159	54	44
CO <sub>2</sub> content (G20)	%	8.8	9.5	9.0	10.8	9.5
Max. smoke capacity (G20)	kg/h	56.9	71.2	77.2	67.2	70.2
Excess air	%	72	83	75	105	83
<b>HEATING CIRCUIT</b>						
Pre-charged pressure of expansion tank	bars			1		
Maximum pressure of the central heating circuit	bars			3		
Expansion tank capacity	L			8		
Maxi/mini central heating temperature: (high temperature range)	°C			82 / 35		
<b>DOMESTIC HOT WATER CIRCUIT</b>						
Max./mini. hot water température	°C			60 / 36		
Specific flow rate of the domestic hot water system (10 min. with $\Delta T=30^{\circ}C$ ) instant boilers	L/min	11.2	13.2	15.1	11.8	13.2
DHW flow rate $\Delta T=25^{\circ}C$	L/min	13.5	15.7	18.5	14.3	16.0
DHW flow rate $\Delta T=35^{\circ}C$	L/min	9.6	11.2	13.2	10.2	11.4
Domestic hot water classification (EN13203)	stars		**	***		**
Minimum DHW flow rate	L/min		2			<2
Max./mimi pressure of domestic hot water	bars		7			7/1
<b>ELECTRICAL PART DATA</b>						
Power supply frequency/voltage	V/Hz			220/50		
Power consumption	W	87	106	106	50	50
Minimum ambient operating temperature	°C			+5		
Electrical systems protection index	IP		X5D			X4D
Weight	kg	29	31	31	27	29

Width  
40-44 cm

Power  
25-30 kW

DHW production  
INSTANT

Technology  
CONVENTIONAL

## PIGMA ULTRA

### COMPONENTS

1. Evacuation connector
2. Air pressure switch
3. Condensate drain
4. Central heating flow temperature sensor
5. Ignition electrodes
6. Burner
7. Secondary heat exchanger
8. Gas valve
9. Safety valve (3 bars)
10. Spark generator
11. Control panel/board
12. Filling valve
13. Central heating circuit filter
14. Circulator with air purge valve
15. DHW flow switch 9
16. Distribution valve
17. On/off switch
18. Central heating return temperature sensor
19. Detection electrode
20. Combustion chamber
21. Main heat exchanger
22. Extractor

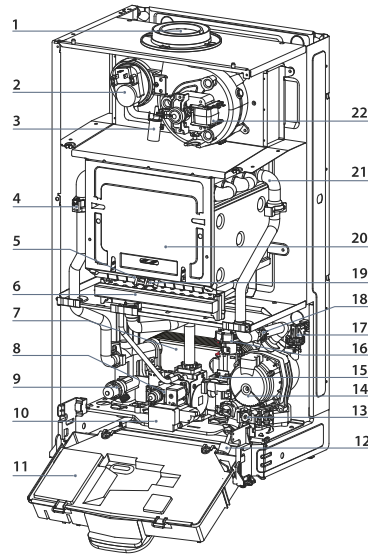

### AVAILABLE MODELS

MODEL	BOILER	BOILER
		Code
<b>WATERTIGHT BOX</b>		
PIGMA ULTRA 25 FF NG	natural	3310530
PIGMA ULTRA 30 FF NG	natura	3310532
PIGMA ULTRA 35 FF NG	natural	3310533
<b>OPEN CHAMBER</b>		
PIGMA ULTRA 30 CF NG	natural	3310531
PIGMA ULTRA 25 CF NG	natural	3310529

### INSTALLATION ACCESSORIES

	Code
66 mm platform (tray) frame kit	3678415
Universal replacement kit	3318227

### CONTROL AND REGULATION DEVICES

WIRED CONTROL	Code
<b>ON-OFF ADJUSTMENT</b>	
Basic control	3318605
Easy control programmable chronothermostat	3318601
<b>MODULATION CONTROL</b>	
Expert Control (IT-GB-FR-BE) – Remote control with room (ambient) sensor included	3318596
Expert Control (SP-PT-GR-HR) – Remote control with room sensor included	3318617
Expert Control (RUS-PL-CZ) – Remote control with room sensor included	3318619
Zone Control - room sensor	3318597
<b>OUTDOOR (EXTERIOR) PROBE</b>	
Outdoor probe	3318599
<b>WIRELESS CONTROL</b>	
<b>ON-OFF ADJUSTMENT</b>	
Easy control programmable chronothermostat	3318602

# PIGMA ULTRA

## DIMENSIONS (mm)

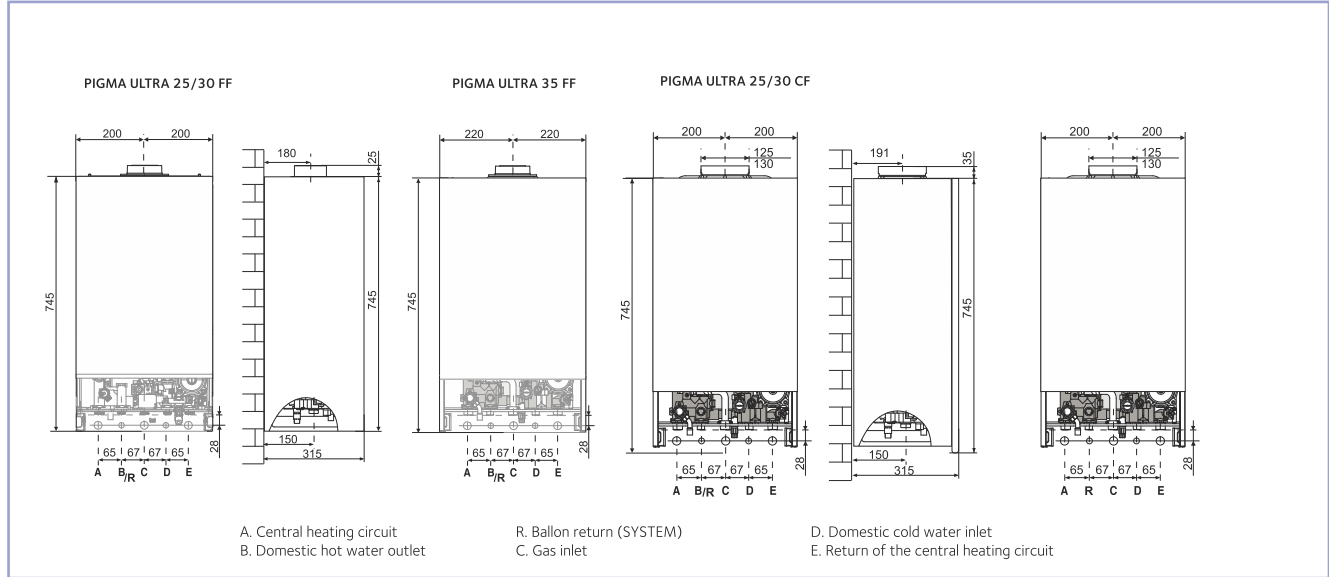

## HYDRAULIC MODULES AND ACCESSORIES

	Code
MGz I evo	3318620
MGz I basic	3318650
MGz II evo	3318621
MGz II basic	3318651
MGz III evo	3318622
MGz III basic	3318652
MGm II evo	3318624
MGm II basic	3318623
MGm III evo	3318625
MGm III basic	3318653
Multifunction kit - 3 zones	3318636
Zone Manager - 3 zones (AT+2BT)	3318628

## RESIDUAL HEIGHT

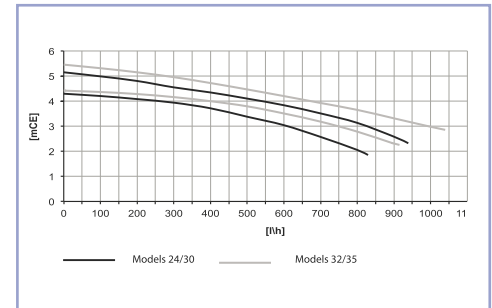

## SMOKE EVACUATION

CONCENTRIC SYSTEMS: C12 - C32	Ø 60/100	Ø 80/125
	Code	Code
Concentric evacuation kit L 750 (mm)	3318001	-
Concentric evacuation kit With vertical outlet	3318002	-
Concentric elbow m/f 90°	3318003	-
Concentric evacuation kit L 1000 (mm)	-	3318035
Vertical flow kit	-	3318040
Black roof evacuation terminal	-	3318013
Red roof evacuation terminal	-	3318014

CONCENTRIC SYSTEM FOR DRIVING COLLECTIVE SMOKE : C42	Ø 60/100
	Code
Concentric evacuation kit 60/100 c42	3318041

DISSOCIATED SYSTEMS	Ø 80/80
	Code
Separate evacuation kit Ø 80 - 80	3318368
Adapter Ø 60/100 to 80 for separate systems	3318367

## INTÉGRATION THERMIQUE SOLAIRE

	Code
Solar probe for mixed boilers	3318317
Manual thermostatic mixing valve	3318379
Thermostatic mixing valve for boilers > 25 kW	3318419
Forced circulation Solar sensor kit	3318485
Heat exchanger module collective solar energy	3024172
Heat exchanger module for collective solar energy with 2-way valve	3024171
Thermostatic mixing valve for heating only	3024085