



WALL – MOUNTED BOILER

ALIXIA ULTRA

Despite its great simplicity, the Alixia Ultra boiler offers all the technical features necessary for optimal, reliable, practical and safe operation. The new ALIXIA ULTRA is now equipped with an LCD screen for easy operation.



> SANITARY (HEALTH) COMFORT

- **Stainless steel heat exchanger for domestic hot water.**
- **Domestic hot water flow rate of 13.5 L/min with $\Delta T = 25 \text{ }^\circ\text{C}$.**
- Domestic hot water circuit controlled by two probes and a flow meter that measures the flow of domestic hot water in order to improve temperature stability according to each type of water draw.

> HEATING COMFORT

- **Anti-freeze function** for the protection of the heating circuit.
- Progressive (gradual) ignition of the burner to increase acoustic comfort and durability of the components.
- Automatic by-pass
- Heating power (capacity) 15-18-24 kW
- Backlit LCD screen with display of operating modes and temperatures.
- Simple and immediate configuration.

> EASE OF USE AND INSTALLATION



- **Compact and perfectly adaptable to any type of housing.**
- Quick installation: system configured to allow the use of hydraulic bars (optional).
- **Simplified maintenance:** all components are accessible from the front
- Model designed for integration into a solar heating system (solar probe included).
- Model designed for wired on-off room (ambient) control.

Width
40 cmPower
15-18-24 kWDHW production
INSTANTTechnology
CONVENTIONAL

ALIXIA ULTRA

CARACTÉRISTIQUES TECHNIQUES

	ALIXIA ULTRA	15 FF	18 FF	20 FF	24 FF	20 CF	24 CF
Type de chaudière		C12-C32-C42-C52-C62-C82-B22-B22p-B32				B11 - B11bs	
ELECTRICAL PERFORMANCE							
Maxi/mini nominal heat flow rate (Hi)	kW	15.0 / 11.0	19.0 / 11.0	25.8 / 11.0	25.8 / 11.0	25.8 / 11.0	25.8 / 11.0
Maxi/mini nominal heat input (Hs)	kW	16.7 / 12.2	21.1 / 12.2	28.7 / 12.2	28.7 / 12.2	28.7 / 12.2	28.7 / 12.2
Maxi/min nominal heat flow rate for hot water (Hi)	kW	25.8 / 11.0	25.8 / 11.0	25.8 / 11.0	25.8 / 11.0	27.0 / 11.0	27.0 / 11.0
Max/min nominal heat flow rate for hot water (Hs)	kW	28.7 / 12.2	28.7 / 12.2	28.7 / 12.2	28.7 / 12.2	30.0 / 12.2	30.0 / 12.2
Maxi/mini heating capacity	kW	13.5 / 9.5	17.8 / 9.5	24.0 / 9.5	24.0 / 9.5	23.7 / 9.9	23.7 / 9.9
Maxi/mini DHW heating capacity	kW	23.6 / 10.0	23.6 / 10.0	23.6 / 10.0	23.6 / 10.0	25.0 / 10.2	25.0 / 10.2
Combustion efficiency (at smoke evacuation) Hi/Hs	%	88.3	93.8	93.7	93.7	92.7	92.7
Gross efficiency of the nominal heat input (60/80°C) Hi/Hs	%	90.2 / 81.2	93.6 / 84.3	93.1 / 83.8	93.1 / 83.8	91.9 / 82.8	91.9 / 82.8
30 % gross yield at 47°C Hi/Hs	%	89.3 / 80.4	92.4 / 83.2	93.3 / 84.0	93.3 / 84.0	91.2 / 82.1	91.2 / 82.1
Efficiency at minimum power Hi/Hs	%	86.7 / 78.1	86.7 / 78.1	86.7 / 78.1	86.7 / 78.1	90.2 / 81.2	90.2 / 81.2
Yield (performance/efficiency) classification (Directive 92/42/CEE)	stars	**		***		**	
Maxi thermal loss through the enclosure (envelope) (ΔT = 50°C)	%	2.7	0.2	0.6	0.6	0.8	0.8
Thermal loss through smoke evacuation when the burner is turned on	%	11.7	6.2	6.3	6.3	7.3	7.3
Thermal loss through smoke evacuation when the burner is turned off	%	0.4	0.4	0.4	0.4	0.4	0.4
EMISSIONS							
Residual evacuation gauge height	Pa	120	120	120	120		
Minimum draw (CF)	Pa					4.1	4.1
NOx class	class			3			2
Temperature of evacuated gas (G20)	°C	115	115	117	117	116	116
CO2 content (G20)	%	3.2	6.5	6.5	6.5	5.4	5.4
CO content (0 % O2)	ppm	40	22	60	60	54	54
O2 content (G20)	%	14.8	8.8	8.8	8.8	10.8	10.8
Max. smoke capacity (G20)	kg/h	56.9	56.9	56.9	56.9	67.2	67.2
Excess air	%	239	72	72	72	105	105
HEATING CIRCUIT							
Pre-load (pre-charge) pressure of expansion tank	bars				1		
Maximum pressure of the central heating circuit	bars				3		
Capacity of the expansion tank	L				8		
Max/min central heating temperature	°C				82 / 35		
DOMESTIC HOT WATER CIRCUIT							
Max/min temperature of domestic hot water	°C				60 / 36		
Specific domestic hot water flow rate (10 min. ΔT=30°C)	L/min	11.2	11.2	11.2	11.2	11.8	11.8
DHW flow rate (ΔT=25 °C)	L/min	13.5	13.5	13.5	13.5	14.3	14.3
DHW flow rate (ΔT=35 °C)	L/min	9.6	9.6	9.6	9.6	10.2	10.2
Domestic hot water classification (EN13203)	stars				**		
Minimum DHW flow rate	L/min				< 2		
Max/min hot water pressure	Mpa				7 / 1		
ELECTRICAL DATA							
Power supply voltage/frequency	V/Hz				220 / 50		
Power consumption	W	112	112	112	112	78	78
Minimum ambient operating temperature	°C				+5		
Electrical systems protection index	IP			X5D		X4D	
Weight	kg	28	28	28	28	26	26

Width
40 cm

Power
15-18-24 kW

DHW production
INSTANT

Technology
CONVENTIONAL

ALIXIA ULTRA

COMPONENTS

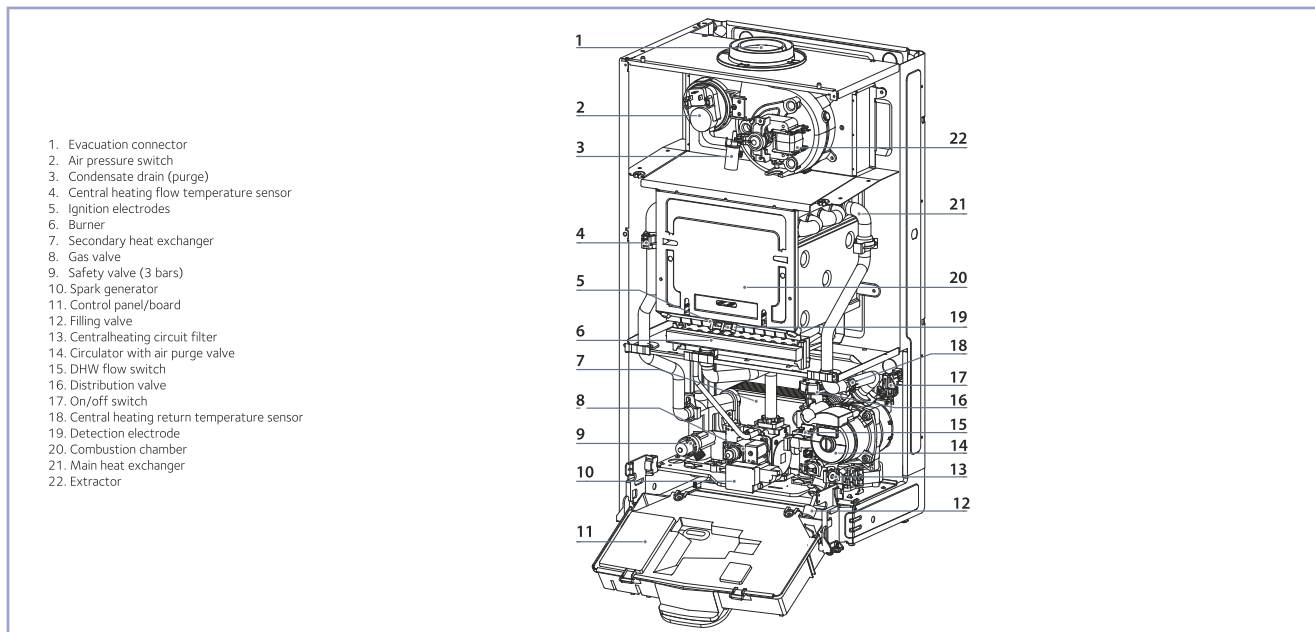

AVAILABLE MODELS

MODEL	POWER	GAS	BOILER
			Code
ALIXIA ULTRA 15 FF NG	15 kW	Natural	3310521
ALIXIA ULTRA 18 FF NG	18 kW	Natural	3310522
ALIXIA ULTRA 20 CF NG TU	20 kW	Natural	3310523
ALIXIA ULTRA 20 FF NG TU	20 kW	Natural	3310524
ALIXIA ULTRA 24 CF NG	24 kW	Natural	3310525
ALIXIA ULTRA 24 FF NG	24 kW	Natural	3310526

INSTALLATION ACCESSORIES

DESCRIPTION	Code
Folding metal template	3318248
Bar kit	3678350
Hydraulic kit (pipes + 4 faucets (taps))	3318924
First installation kit (pipes + 2 faucets)	3318224
Site (construction) kit	3318222
2 heating faucet kits	3318225
Universal replacement kit	3318227
66 mm platform frame (tray) kit	3678415

CONTROL AND REGULATION DEVICES

DESCRIPTION	Code
Wired timer thermostat	3318601
ON/OFF room (ambient) thermostat	3318605

ALIXIA ULTRA

DIMENSIONS (mm)

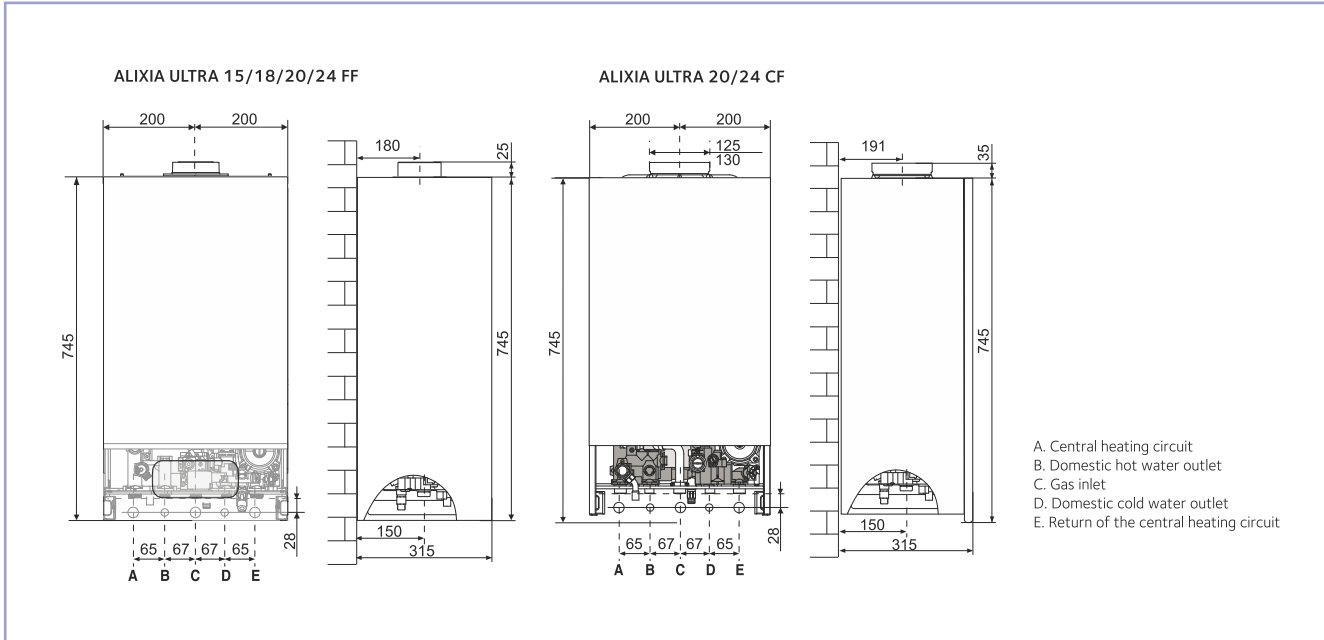

SMOKE EVACUATION

DESCRIPTION	Code
Vertical start (flow) 60/100 cond. coll. boiler	3318008
Concentric evacuation kit 60/100 L 1000	3318000
Vertical flow 60/100-80/125 cond. coll. boiler	3318040
Concentric evacuation kit 80/125 L 1000	3318035
Adapter \varnothing 60/10-80 for separate systems	3318367
Separate evacuation kit \varnothing 80+80	3318368

N.B. : For other installation configurations and to find out about all the other smoke evacuation accessories, please refer to the BOILER ACCESSORIES section.

RESIDUAL HEIGHT

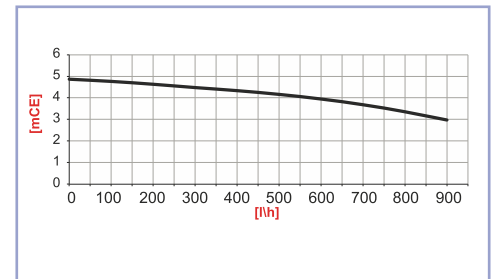

GAS CONVERSION KIT

DESCRIPTION	Code
LPG conversion kit for traditional boilers, models 24-25 kW CF-FF	3318261
Propane-air mix conversion kit for conventional boilers models 24-25 kW CF-FF et 30 kW CF	3318268

SOLAR THERMAL INTEGRATION

DESCRIPTION	Code
Solar probe/sensor (included)	3318317
Thermostatic mixing valve	3318379