

CALYPSO ECO



CALYPSO ECO features a copper heating element screw-fixed to the structure.

Although being the entry-level model, it is equipped with a high performing element, with extended longevity.

ELEMENT

Copper

RANGE

Vertical 50 - 80 - 100 - 120 - 150

Horizontal 50 - 80 - 100 - 120 - 150

REGULATION

Internal through screw



STANDARD FEATURES

As per standard product



STEEL EPOXY
POWDER
COATED JACKET



HIGH LIQUID INTRUSION
PROTECTION



BLUE SILICON
ENAMELLING



OPERATING LIGHT

EXTRA FEATURES

Further customization is possible on factory-tailored production lots



HEAVY-DUTY
THERMOSTAT



POWER CABLE
AND PLUG



HIGHER POWER



DIMENSIONS

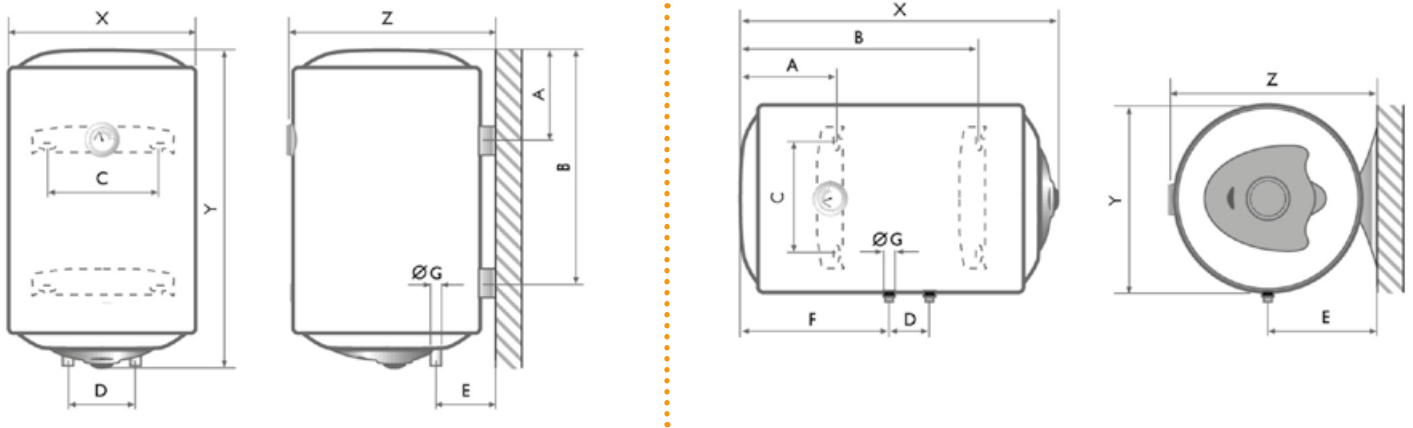

Vertical

Max operating pressure: 8 bar
Voltage: 220~240 V 50-60 Hz

Horizontal

TECHNICAL DATA

VERTICAL EXECUTION			50 VE	80 VE	100 VE	120 VE	150 VE
Dimensions	X	mm	440	440	440	440	440
	Y	mm	555	755	995	1130	1175
	Z	mm	460	460	460	460	460
	A	mm	185	185	185	190	190
	B	mm	/	/	/	915	955
	C	mm	265	265	265	265	265
	D	mm	100	100	100	100	100
	E	mm	130	130	130	130	130
Capacity		litres	50	80	100	120	150
Power		W	1500	1500	1500	1500	1500
Heating time	ΔT 35° C	minutes	1 h 26'	2 h 18'	2 h 53'	3 h 28'	4 h 19'
	ΔT 45° C	minutes	1 h 51'	2 h 58'	3 h 42'	4 h 27'	5 h 34'
Weight		Kg	16	20,5	25	28,5	29,5

HORIZONTAL EXECUTION			50 HO	80 HO	100 HO	120 HO	150 HO
Dimensions	X	mm	565	770	990	1135	1255
	Y	mm	440	440	440	440	440
	Z	mm	460	460	460	460	460
	A	mm	200	180	200	190	200
	B	mm	345	555	740	915	955
	C	mm	265	265	265	265	265
	D	mm	100	100	100	100	100
	E	mm	230	230	230	230	230
	F	mm	180	355	570	720	760
Capacity		litres	50	80	100	120	150
Power		W	1500	1500	1500	1500	1500
Heating time	ΔT 35° C	minutes	1 h 26'	2 h 18'	2 h 53'	3 h 28'	4 h 19'
	ΔT 45° C	minutes	1 h 51'	2 h 58'	3 h 42'	4 h 27'	5 h 34'
Weight		Kg	16	20,5	25	28,5	29,5