

## Wilo-Yonos PARA High Flow



**de** Einbau- und Betriebsanleitung  
**en** Installation and operating instructions  
**fr** Notice de montage et de mise en service

**it** Istruzioni di montaggio, uso e manutenzione  
**sv** Monterings- och skötselanvisning  
**tr** Montaj ve kullanma kılavuzu

Fig. 1a:

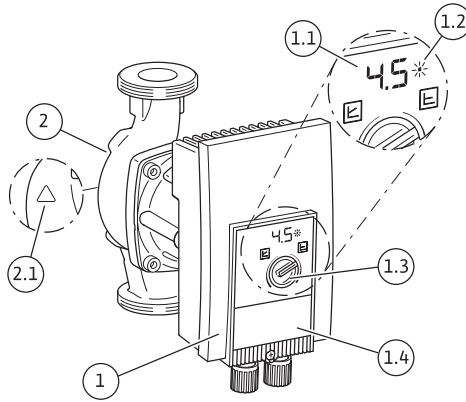

Fig. 1b:

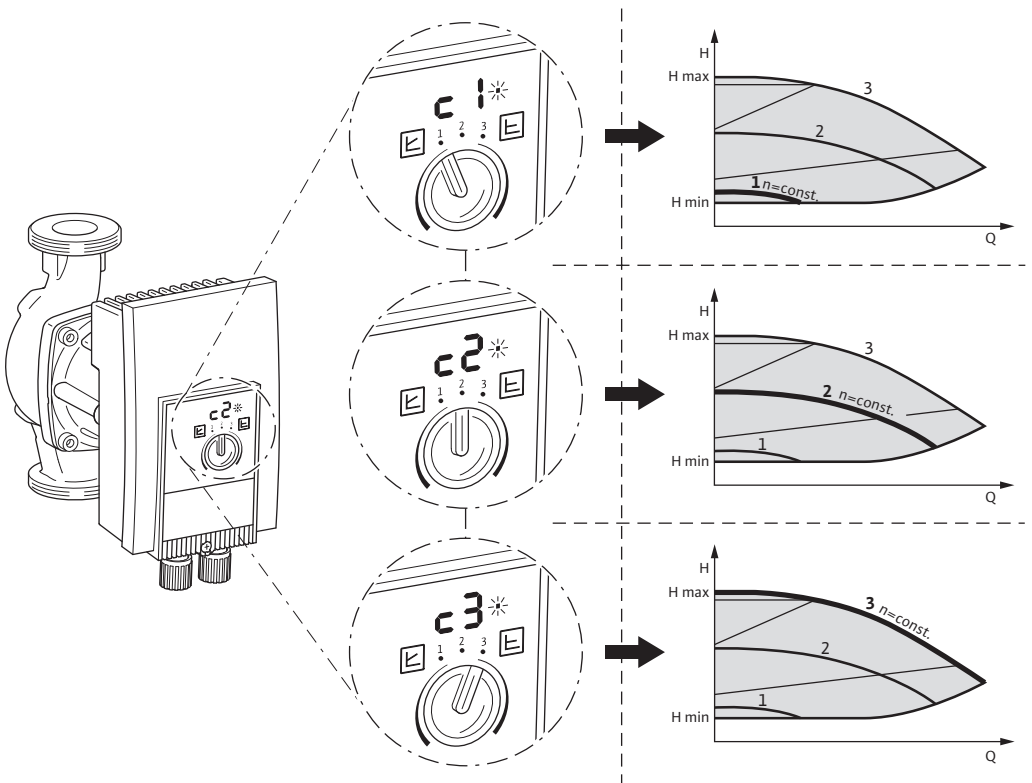

Fig. 2:

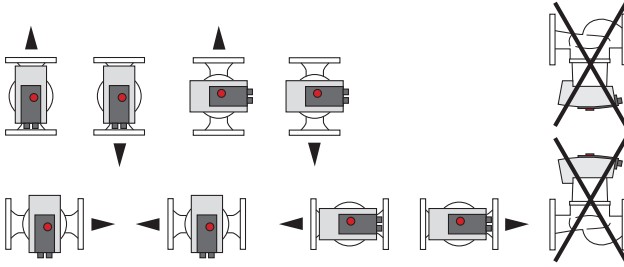

Fig. 3a:

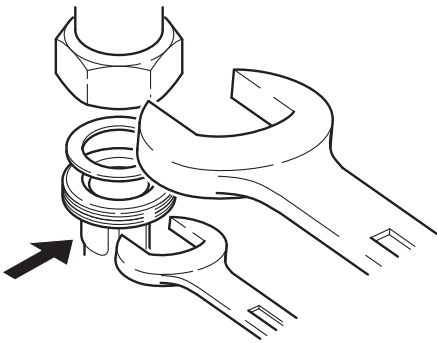

Fig. 3b:

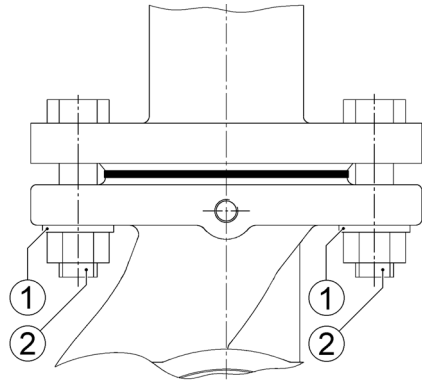

Fig. 4a:

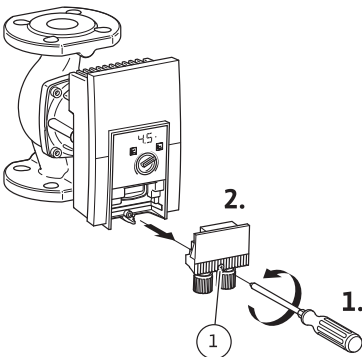

Fig. 4b:

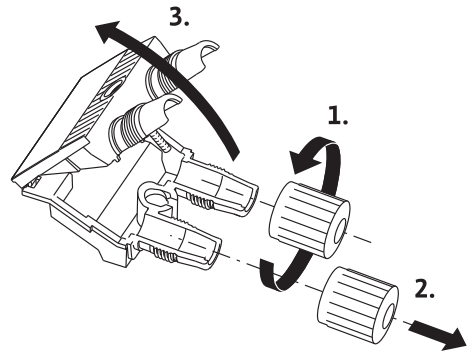

Fig. 4c:

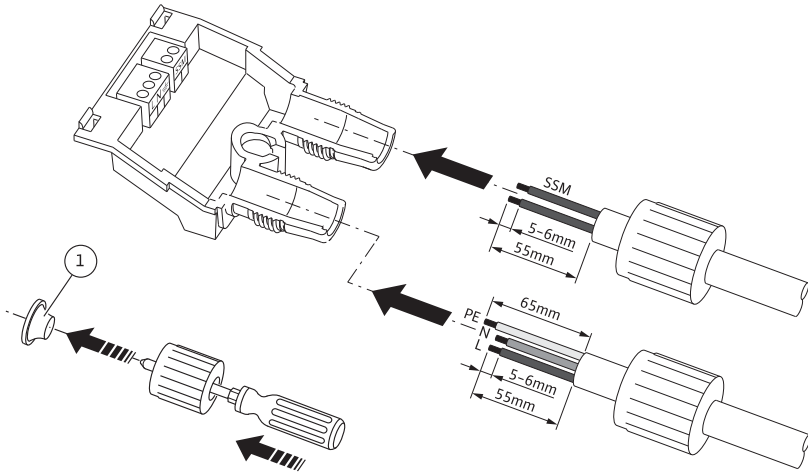

Fig. 4d:

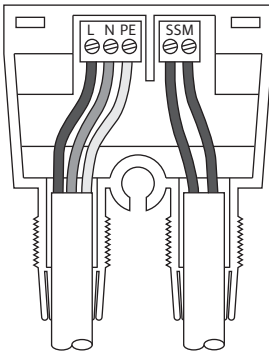

Fig. 4e:

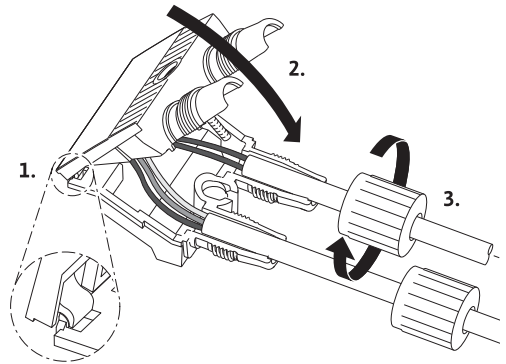

Fig. 4f:

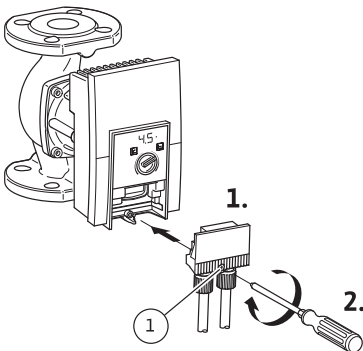
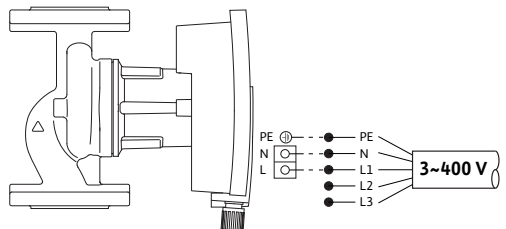

Fig. 5:



5.2 Technical data	
Max. flow rate	depends on the pump type, see catalogue
Max. delivery head	depends on the pump type, see catalogue
speed	depends on the pump type, see catalogue
Mains voltage	1~230 V $\pm 10\%$ in acc. with DIN IEC 60038
Frequency	50/60 Hz
Rated current	see rating plate
Energy Efficiency Index (EEI)	see rating plate
Insulation class	see rating plate
Protection class	see rating plate
Power consumption $P_1$	see rating plate
Nominal diameters	see type key
Connection flanges	see type key
Pump weight	depends on the pump type, see catalogue
Permissible ambient temperature	$-20^{\circ}\text{C}$ to $+40^{\circ}\text{C}$ <sup>1)</sup>
Permissible fluid temperature	$-20^{\circ}\text{C}$ to $+110^{\circ}\text{C}$ <sup>1)</sup>
Temperature class	TF110
Max. rel. humidity	$\leq 95\%$
Degree of pollution	2 (IEC 60664-1)
Max. permissible operating pressure	see rating plate
Approved fluids Wilo-Yonos PARA Hig Flow	<p>Heating water (in acc. with VDI 2035/VdTÜV Tch 1466) water/glycol mixtures, max. mixing ratio 1:1 (for mixtures with glycol the conveying data of the pump should be corrected to those for the higher viscosity, depending on the percentage mixing ratio)</p> <p>Only use brand-name goods with corrosion protection inhibitors; comply with the manufacturer's specifications and safety data sheets.</p> <p><b>The pump manufacturer's approval must be obtained for the use of other fluids.</b></p> <p>Ethylene/propylene glycol with corrosion inhibitors. No oxygen binders, no chemical sealants (pay attention to system sealed with regard to corrosion technology according to VDI 2035; leaks must be reworked). Commercially available anti-corrosion agents <sup>2)</sup> without anodic inhibitors with a corrosive effect (e.g. underdosing due to consumption). Commercially available combination products <sup>2)</sup> without inorganic or polymer film formers Commercially available cooling brines <sup>2)</sup></p>
Emission sound-pressure level	$< 52$ dB(A) (depending on the pump type)
Residual current $\Delta I$	$\leq 3.5$ mA (see also section 7.2)
Electromagnetic compatibility	<p>Emitted interference in acc. with: EN 61800-3:2004+A1:2012 / Residential (C1)</p> <p>Interference resistance in acc. with EN 61800-3:2004+A1:2012 / Industrial (C2)</p>

<sup>1)</sup> The pump is equipped with a power limiting function which provides protection against overload. This can have an effect on the output depending on operation.

<sup>2)</sup> See the following warning